



Firle Close, Hastings TN35 5ET

Offers in excess of £160,000



Two bedroom GARDEN APARTMENT, set on the GROUND FLOOR of this purpose built building. It's conveniently positioned within easy reach of Ore Village, local shops and good transport links. Accessed via a private entrance the accommodation here is WELL PRESENTED THROUGHOUT standard and enjoys well proportioned rooms, the living room enjoys a front aspect while the modern fitted kitchen sits at the rear of the property with a separate utility room and access out to the garden. There are TWO DOUBLE BEDROOMS and a newly fitted family bathroom with a shower and screen over the bath. Externally there is a private area of rear garden which is mainly laid to lawn with an area of decking.

GROUND FLOOR 725 sq.ft. (67.4 sq.m.) approx.

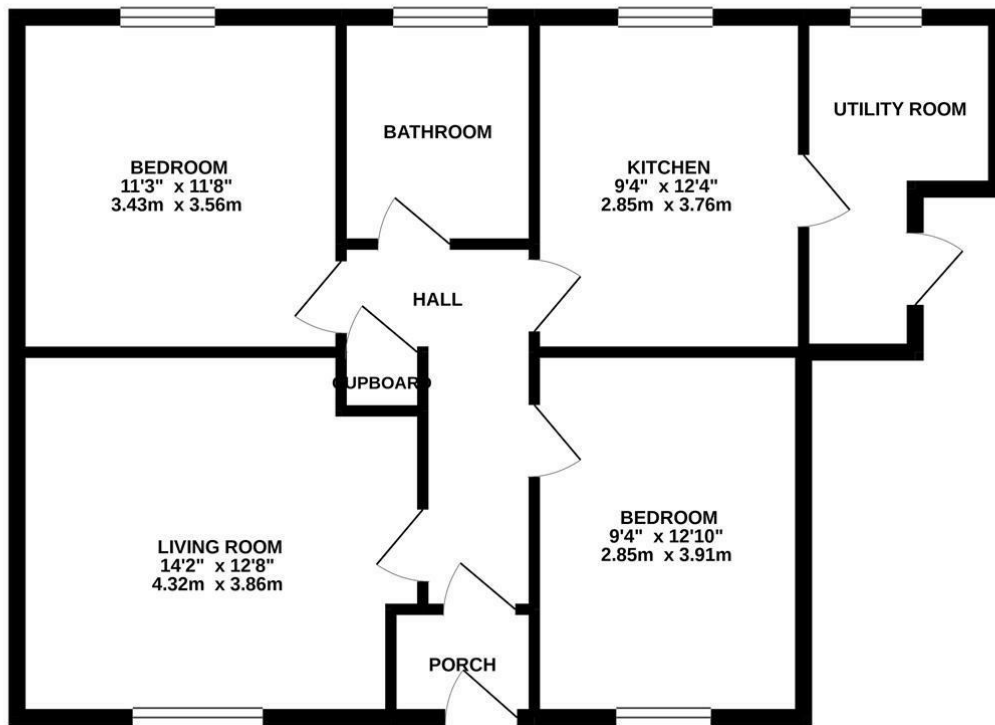

TOTAL FLOOR AREA : 725 sq.ft. (67.4 sq.m.) approx.

Whilst every attempt has been made to ensure the accuracy of the floorplan contained here, measurements of doors, windows, rooms and any other items are approximate and no responsibility is taken for any error, omission or mis-statement. This plan is for illustrative purposes only and should be used as such by any prospective purchaser. The services, systems and appliances shown have not been tested and no guarantee as to their operability or efficiency can be given.

Made with Metropix ©2021

